

ASSEMBLING INSTRUCTIONS CYLINDER 321M

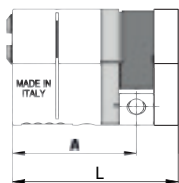
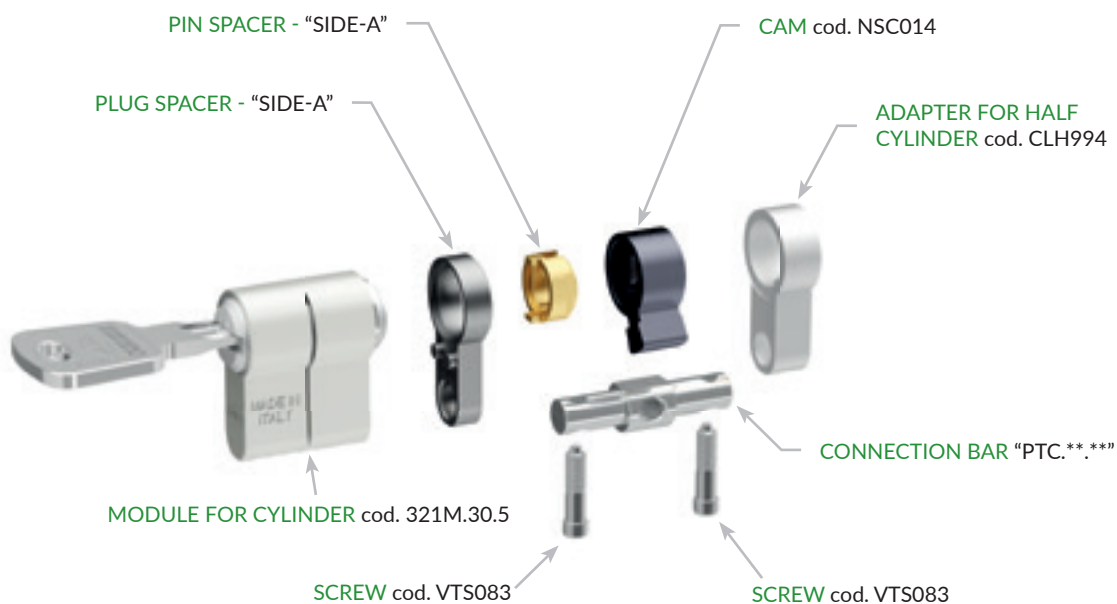

COD.	L	SIDE "A"				BAR	
		A	CYLINDER SPACER	+	PLUG SPACER	CONNECTION BAR	UNIVERSAL CONNECTION BAR
321M.30.13.5	43	30	/		/	PTC.30.30	PTC182
321M.35.13.5	48	35	PTC003		NGM087	PTC.30.35	PTC181
321M.40.13.5	53	40	PTC004		NGM088	PTC.30.40	PTC182
321M.45.13.5	58	45	PTC005		NGM089	PTC.30.45	PTC181
321M.50.13.5	63	50	PTC006		NGM090	PTC.30.50	PTC182
321M.55.13.5	68	55	PTC006 PTC003		NGM090 NGM087	PTC.30.55	PTC181
321M.60.13.5	73	60	PTC006 PTC004		NGM090 NGM088	PTC.30.60	PTC182
321M.65.13.5	78	65	PTC006 PTC005		NGM090 NGM089	PTC.30.65	PTC181
321M.70.13.5	83	70	N°2 PTC006		N°2 NGM090	PTC.30.70	PTC182
321M.80.13.5	93	80	N°2 PTC006 PTC004		N°2 NGM090 NGM088	PTC.30.80	PTC182