

# Door Viewer Extension

## Product Data Sheet



### Description:

The high-quality door viewer extension can be used to extend the TS 680 door viewer.

- suitable for door thicknesses from 58 mm
- extension: 10-15 mm
- optional for TS 680 viewer
- material: brass

### Illustration:



### Technical Details:

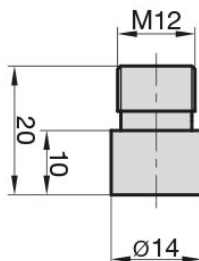

### Details:

<b>Order no.</b>
6890-0000
<b>Weight</b>
7 g
<b>Pricegroup</b>
21
<b>EAN</b>
 4 026434 080193