

DEAD AND ADJUSTABLE LATCH BOLT

Latch bolt interchangeable with roller bolt cod. 01435 (but cod.1300.20.**)

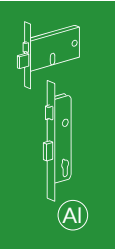
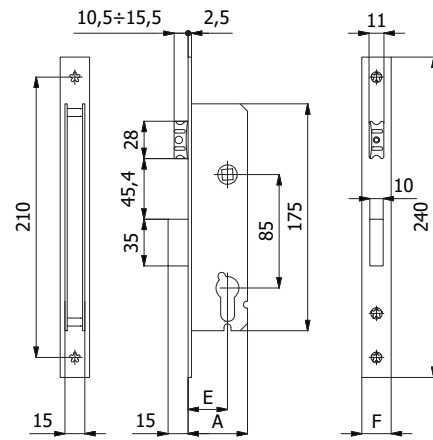

CONSTRUCTIVE FEATURES:

Zinc and plastic plated steel case and cover - Stainless steel forend - Nickel-plated special alloy dead bolt - Nickel-plated special alloy anti-noise latch bolt - Zinc-plated special alloy square spindle device \varnothing 8 mm.

WORKING:

Key driven dead bolt - Handle or key driven latch bolt.

HAND:

Reversible.

PROVIDED WITH:

Cylinder screw.

COD.	E	F	A	Throws			
1300.20.16	20	16	35	1	0,38	1	10
1300.20.22	20	22	35	1	0,42	1	10
1300.20.25	20	25	35	1	0,44	1	10
1300.25.16	25	16	40	1	0,41	1	10
1300.25.22	25	22	40	1	0,45	1	10
1300.25.25	25	25	40	1	0,47	1	10
1300.30.16	30	16	45	1	0,44	1	10
1300.30.22	30	22	45	1	0,48	1	10
1300.30.25	30	25	45	1	0,50	1	10
1300.35.16	35	16	50	1	0,47	1	10
1300.35.22	35	22	50	1	0,51	1	10
1300.35.25	35	25	50	1	0,53	1	10
1300.40.16	40	16	55	1	0,50	1	10
1300.40.22	40	22	55	1	0,54	1	10
1300.40.25	40	25	55	1	0,56	1	10