

Thermal magnetic circuit breaker axis lockouts

C1
C2
C3

FEATURES

- Devices designed to block switches of different sizes on a distribution panel.
- Made of nylon with 30% fiberglass load for greater strength.
- Stainless steel pins and bolts.
- Resistant to chemicals and extreme temperatures.
- Available for single and multi-pole switches.
- Adjustment by screw system.
- Padlocking with a maximum shackle diameter of 6 mm.

DIMENSIONS

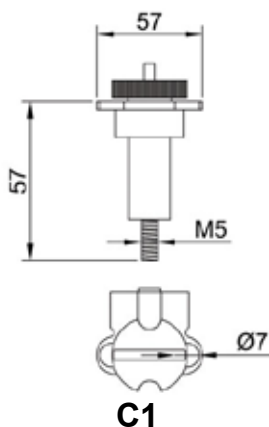
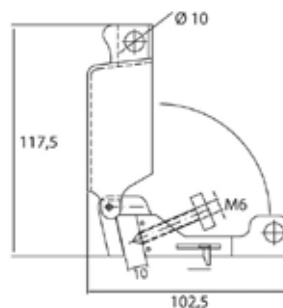
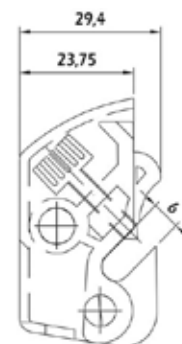
C1

C2

C3